

Bowring Close

HARTCLIFFE

APPROXIMATE FLOOR AREA
114.9 SQM / 1237 SQFT



GROUND FLOOR

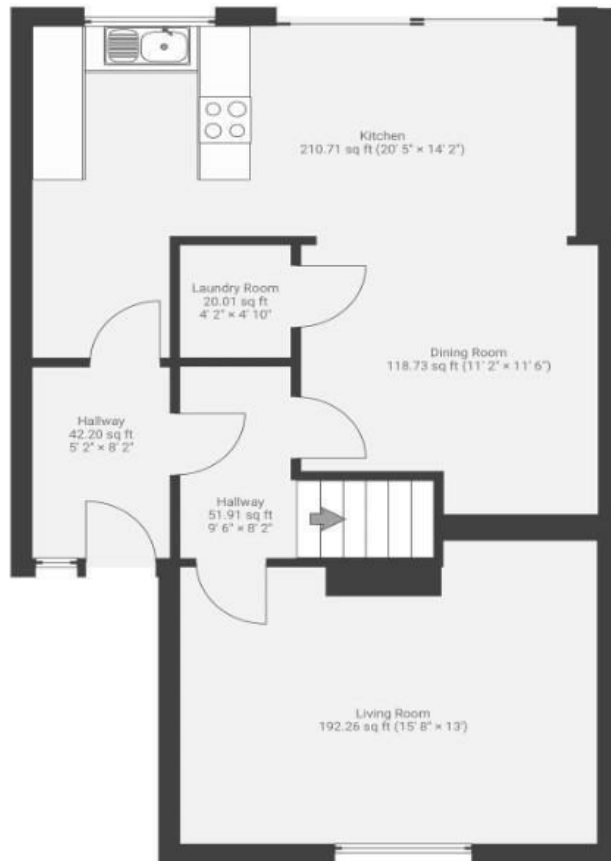

FIRST FLOOR

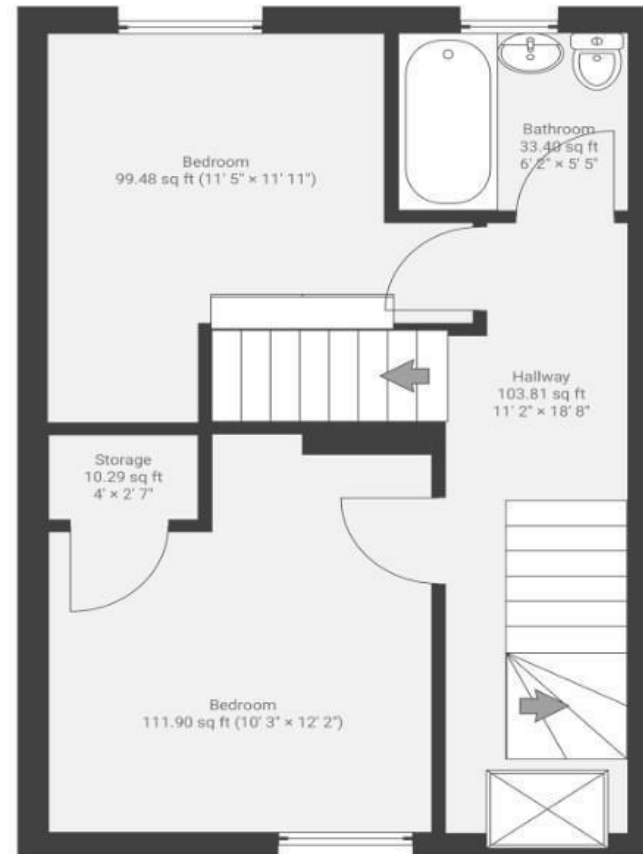

SECOND FLOOR



Illustrations are for reference purposes only, measurements are approximate, not to scale.

Boardwalk

Bowring Close

, BRISTOL

£

£300,000



BS13 0DH

zzz

3 Bedrooms



1 Bathrooms

"We wanted a house with a view, and once we looked out of the window, I knew it was for us. Within a minute's walk, you are heading up the fields towards Dundry, where you can enjoy the scenery of Bristol - especially lovely during the Balloon Fiesta and Bonfire Night. We have spent many hours walking through the stream and fields. We have extended and updated our home as our family has grown and have loved every minute - even the very messy ones."

